



SOFT 0 to 7

Attends Soft are a range of discreet absorbent liners and pads for sensitive skin and can be worn in normal underwear. They are designed to manage very light to heavy urinary incontinence.



Fitting Guide

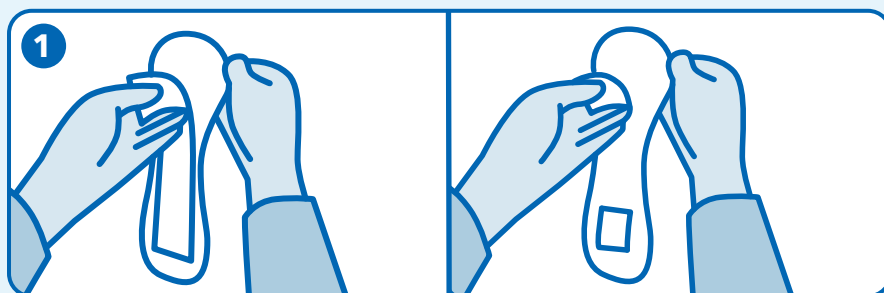

1
One adhesive tape
(applicable to Soft 0 to 4).
Remove the adhesive tape
on the back of the pad.

Two-part adhesive tape
(applicable to Soft 5 to 7).
Remove the adhesive tapes
on the back of the pad.

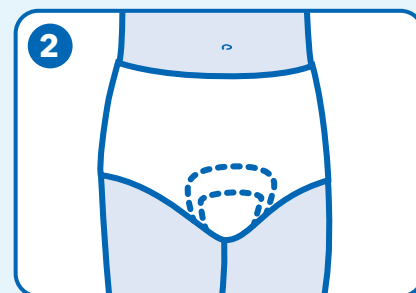

2
Place the pad securely in your
own close fitting underwear.

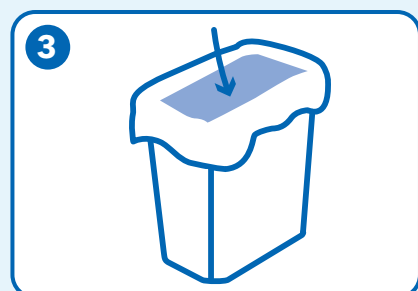

3
After use, roll up the used pads
and dispose of them in general
waste.

SOFT 0 to 7

Hints and Tips

Selection

- Please select the correct product absorption level.
- For optimal performance, we suggest using the product in combination with close fitting underwear.
- Choosing the smallest absorbency level helps to reduce waste.

Disposal

- Roll up pads and dispose of as per your local authority or NHS waste policy.
- You may use the single wrap, if provided, to dispose of the product.
- Do not flush the pad down the toilet.



Skin tolerability is dermatologically approved by proderm Institute for Applied Dermatological Research